

Polaroid

ID100

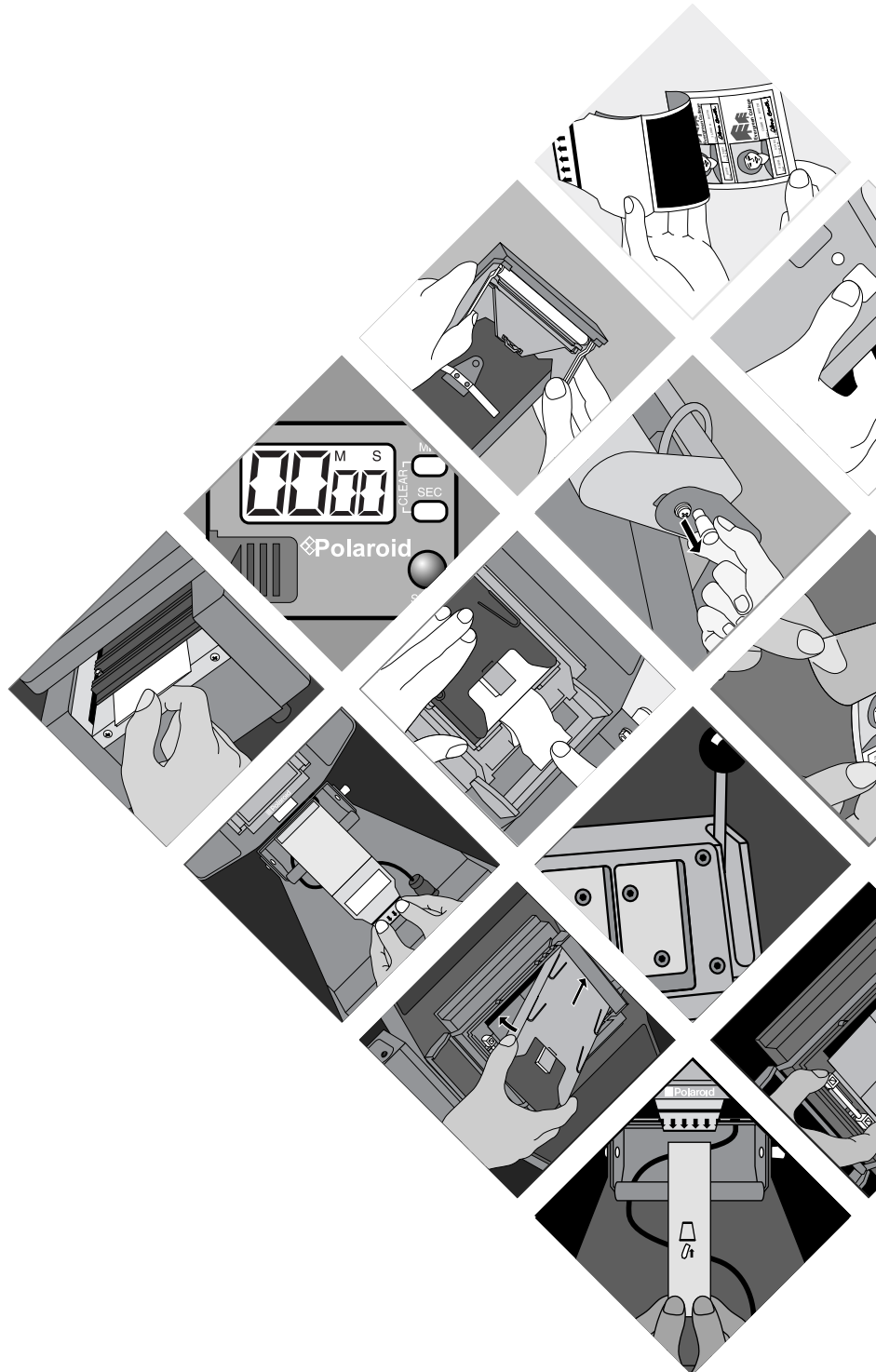

Contents

- 1 Introduction
- 1 Select a Work Area
- 2 Camera, Laminator, and Die Cutter Setup
- 2 Set the Processing Timer
- 3 Install the Validation Plate
- 3 Load the Film
- 4 About the Camera Controls
- 4 Take the Picture
- 4 Process the Film
- 5 Cut the Print
- 5 Laminate the Pictures
- 6 Change the Data Card and Picture Contrast
- 6 Clean the Developer Rollers
- 6 Replace the Batteries
- 7 Adjust the Laminator Thermostat
- 7 Storing the System
- 7 Troubleshooting
- 8 Problem/Solution Table
- 8 Technical Assistance

Introduction

The ID-100 Systems produce instant, color identification cards, which combine a picture of the subject with data or information about the subject. The dual-position camera has one position for taking pictures; the other position for storage and transport.

Select a Work Area

You need an area about 8 ft x 10 ft (2.4 m x 3 m), as shown in the figure.

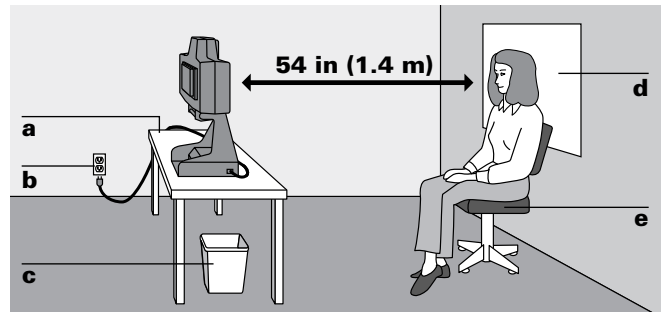

- a** table, approximately 30 inches (76 cm) high
- b** grounded electrical outlet
- c** wastebasket
- d** non-reflective backdrop, approximately 30 inches (76 cm) square
- e** chair approximately 18 inches (45 cm) high

Note: Figure shows recommended distance from subject to camera lens. If your system has been modified for close-up pictures, the correct distance is 40 in (1.0 m).

“Polaroid,” “Polacolor” and “Identifilm” are trademarks of Polaroid Corporation, Cambridge, MA 02139 U.S.A.

PW-17133M-1 June, 1999

Camera, Laminator, and Die Cutter Setup

System must be grounded using a power cord with a three-pronged grounded plug (applies only in countries with grounded electrical supplies), which must be plugged into an appropriate outlet. Do not under any circumstances remove ground prong from plug. If extension cord is needed, use cord with grounded plug and suitable power rating.

- 1 Pull the knob and hold it out.

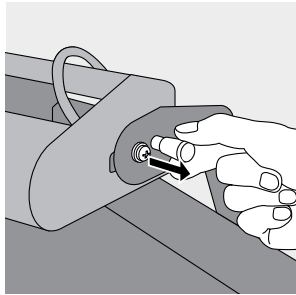

- 2 Grasp the camera and swing it into the upright position. The camera head locks into position.

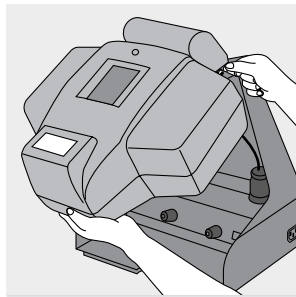

- 3 Plug in the camera power cord, and then connect it to the electrical outlet.

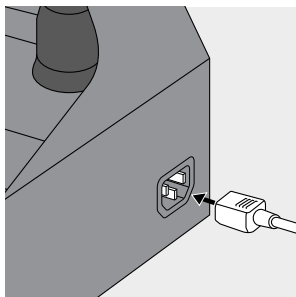

- 4 Place the laminator in a convenient location, and then place the die cutter on top.

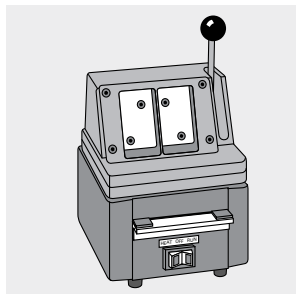

- 5 Plug the laminator power cord into the camera base.

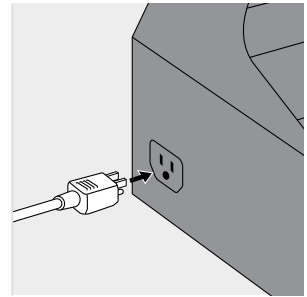

- 6 Turn the key to turn on the camera system power; move the laminator switch to the heat position.

Note: The laminator must warm up for 5 minutes before use.

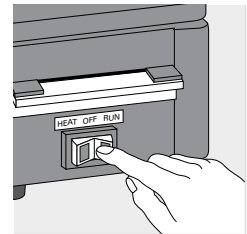
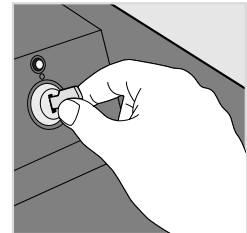

Set the Processing Timer

Before setting the timer, remove the insulation strip (a) protecting the timer's battery during shipment.

- 1 Press the MIN button to set minutes (larger numbers). The next higher number appears with each press. It displays "01" after the first press, "02" after the second.

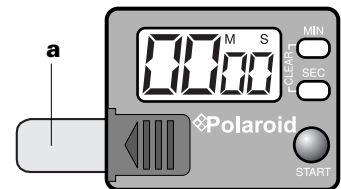

- 2 Press the SEC button, to set seconds (smaller numbers). The next higher number appears with each press. It displays "01" for one second or "10" for ten seconds.

- 3 Press START to start the timer.

- 4 Press the MIN and SEC buttons simultaneously, to clear the numbers.

Replacement battery: The timer uses one #LR44 or equivalent battery. They can be purchased wherever watch, calculator, or hearing aid batteries are sold.

Install the Validation Plate

The validation plate determines the location of the portrait on the ID card. The validation plate may include a validating signature or seal for additional security. Contact your Polaroid dealer or representative for details and ordering information.

1 Open the film door.



2 Hold the validation plate by the bottom tab.

3 Insert the top end of the plate so the center tab fits under, and the side tabs fit over the center rod. The slot in the center tab engages a pin inside the holder.

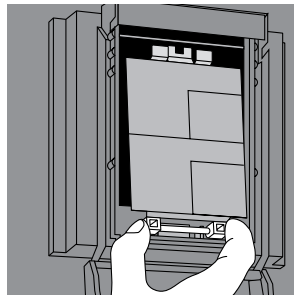

4 Move the plate from side to side. If inserted correctly, it should only move slightly.

5 Insert the bottom of the plate into the holder so the bar pushes in the spring.

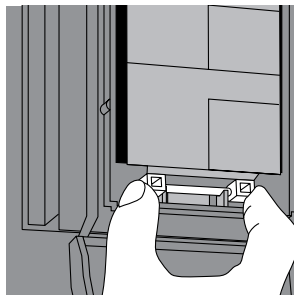

6 Push in and down until the plate snaps into place.

To Remove the Plate

Grasp the sides of the plate near the bottom edge, and lift the plate up and out.

Load the Film

The ID-100 Systems use Polaroid instant color films, such as:

- Polacolor 100 ID UV film
- Polacolor ID Ultraviolet (U.S.A. only)
- Polacolor T681
- IdentiFilm
- Polacolor ER type 669

Each film pack produces ten 8 3/4 in x 4 1/4 in (8.5 cm x 10.8 cm) sheets. The camera produces two ID card photographs on each sheet (20 ID cards/pack).

Before loading film, check that the developer rollers are clean. See the section *Clean the Developer Rollers*.

1 Open the film door.

2 Hold the film pack by the edges and slide it in at an angle. Then push it down into place.

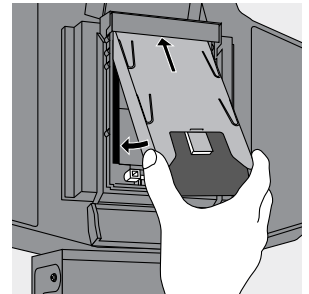

3 Check that the white leader tabs are not caught between the pack and the holder.

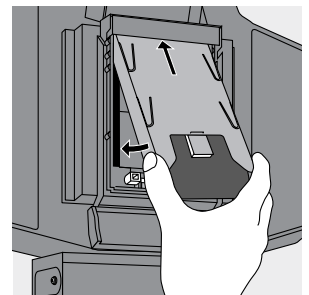

4 Close and latch the door with the black tab sticking out.

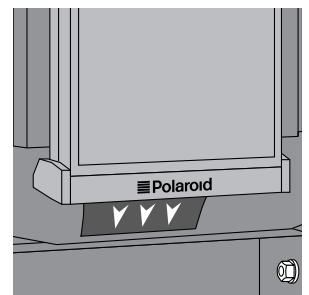

5 Pull the black safety cover straight, all the way out of the holder. A white leader tab appears. If not, see the section *No leader tab?*

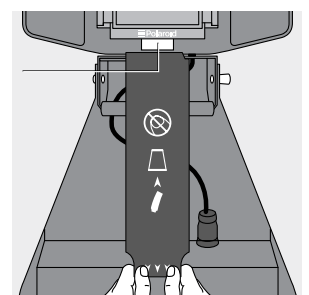

About the Camera Controls

The control panel on the ID-100 Systems has indicators, knobs, and a selector switch.

- The indicators light up as a reminder of the next step and the camera does not operate until each step is completed.
- The knobs allow you to lighten or darken the data card or the subject picture.
- The selector switch allows you to produce two identical or two different ID cards on one sheet of film.
- The face brightener is used for increased strobe outlet for a single photograph.

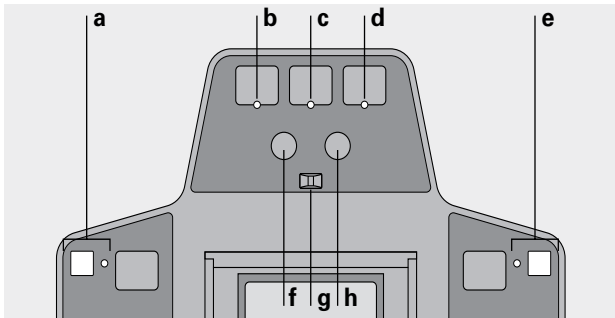

Indicators for each step

- a** Face brightener ON
- b** Pull film tabs
- c** Insert date card
- d** Remove data card
- e** Aim camera and take picture

Knobs and Switch

- f** The picture Lighten/Darken Control
- g** The Card Selector Switch
- h** The card data Lighten/Darken Control

Take the Picture

Note: The indicators on the control panel light up to remind you of the next step. The camera does not operate until each step is completed. Make sure the card selector switch is in the correct position for the picture you need to take (duplicate or single).

- 1 Take the data card from the subject.
- 2 Orient the card so that you can read it, and then slide it all the way into the slot.

Note: In some camera models, the slot is on the right hand side of the camera. The slot is on the top of the camera for the vertical model. With the Pro model, the data card holder is removable for easy cleaning.

- 3 Grip the sides of the camera, and tilt it as needed to place the aiming light on the subject's chin. The aiming light stays on for 10-15 seconds.

If the aiming light goes off before you have aimed the camera, press the shutter button lightly to turn it on again. The camera will not take a picture if the aim light goes out.

- 4 Press the shutter button firmly to take the picture.

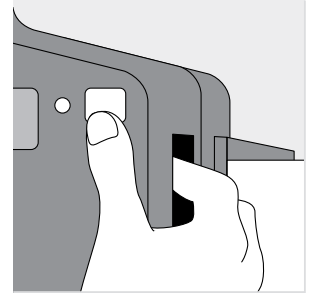

- 5 If you are taking two identical pictures, process the film. If the second picture is a different subject, remove the data card, and insert the next data card.
- 6 Aim the camera and take the second picture.

Process the Film

Important: Pull the film tabs straight, all the way out of the holder.

- 1 Pull the leader tab straight, all the way out of the holder.

A processing tab with arrows appears. If not, see the section *No Processing Tabs?*

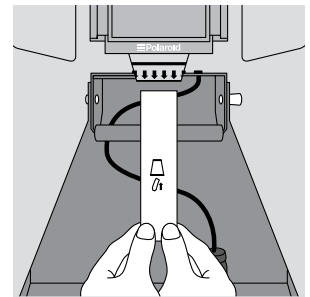

- 2 Grip the processing tab firmly, and pull straight at a moderate speed without hesitation, all the way out of the holder.

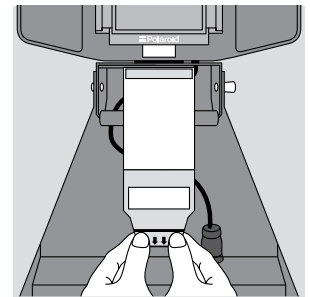

- 3 Press the timer START button.

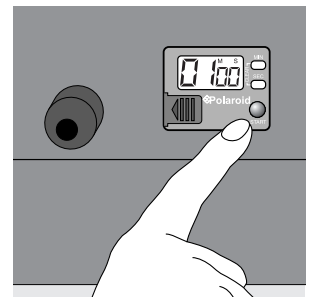

- Place the sheet of film near the timer. At the end of the processing time, the timer beeps.

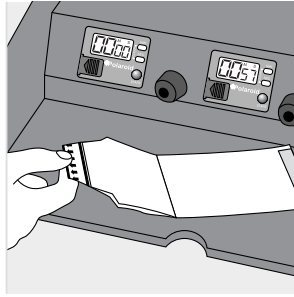

- Separate the print from the negative, starting at the end nearest the arrows.

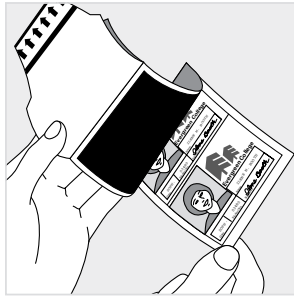

- Fold the negative, moist side in and dispose of it properly. See the film packaging for recommended film handling and cautions.

Cut the Print

- Insert the print into the die cutter as shown.

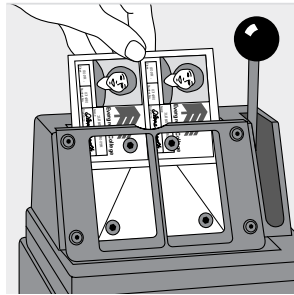

- Ensure that the pictures are centered left to right.

- Push down on the handle to cut the picture into two ID cards.

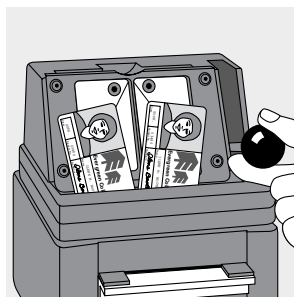

- Release the handle, and then remove the excess paper from the die cutter.



Laminate the Pictures

Most ID cards are sealed or laminated inside a plastic pouch for protection.

Plastic pouches are designed for use with wet, newly separated pictures, or with dry pictures.

The following list provides guidelines for the type of pouch you use for your ID pictures (wet or dry pictures):

Pouch Types

- Front and back are transparent**
 Use with wet or dry pictures.
 Insert a wet picture into the pouch with the picture facing the side imprinted with the word Polaroid.
 Insert a dry picture facing the non-printed side.
- Polaroid-printed transparent front and opaque back**
 Wet pictures only.
- Non-printed transparent front and opaque back**
 Dry pictures only.

Note: If the edges of the ID card are ragged, the laminator thermostat may be set too high. If the pouch is not completely sealed, the laminator thermostat may be set too low. See the section *Adjust the Laminator Thermostat*.

- Move the laminator switch to the right to turn on the rollers.
- Place the picture inside the pouch.

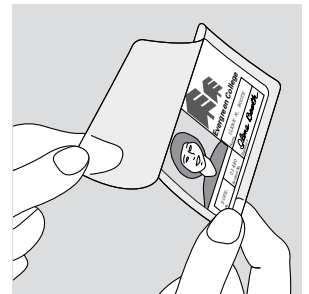

- Place the pouch inside the carrier with the sealed side of the pouch against the closed side of the carrier.

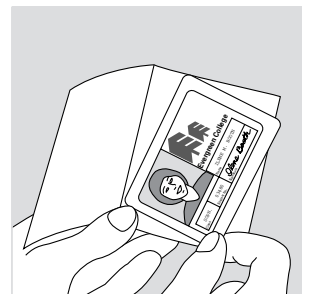

- 4 Insert the carrier into the laminator.

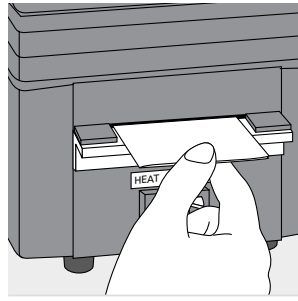

- 5 Allow the carrier to cool for several seconds before removing it.

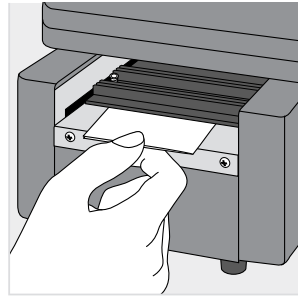

- 6 Open the carrier and remove the laminated card. Do not bend or flex the card until it is cool.

Change the Data Card and Picture Contrast

You have the option of making the data card or the picture of the subject either lighter or darker as shown in the figure.

- a Data card contrast can be changed
- b Picture contrast can be changed

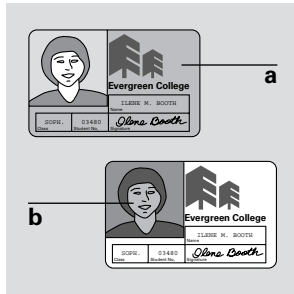

To change the contrast:

- a Turn this knob to lighten or darken the picture
- b Turn this knob to lighten or darken the data card

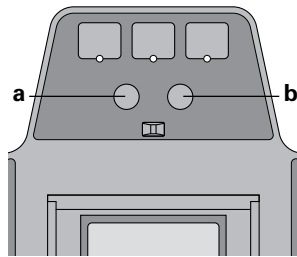

Clean the Developer Rollers

Dirt on the developer rollers can cause spots on pictures and jammed film.

Important: Do not scrape the rollers with sharp objects or disassemble the rollers. Do not use chemicals or abrasive cleaners to clean the rollers. Cleaning the rollers after every 6 packs of film is recommended.

- 1 Lift the steel loops and remove the roller assembly.

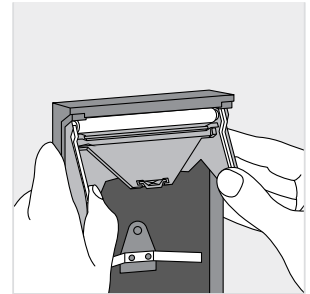

- 2 Clean both rollers with a soft, lint-free cloth dampened with water. Or, hold the roller assembly under clean running water.

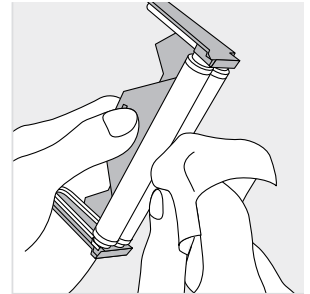

- 3 Rotate both rollers as you clean them to make sure they are free of dirt.

- 4 Clean the film tab slot, and then replace the roller assembly.

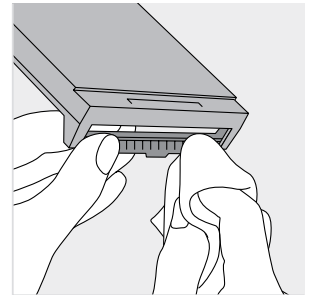

Replace the Battery

If the timer stops working or if the display fades, you need to replace the LR44 or equivalent battery.

- 1 Open the battery door.

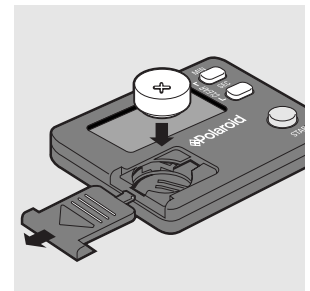

- 2 Insert the new batteries in the orientation (+/-) shown inside the compartment.
- 3 Press the SET and START buttons simultaneously to make sure the timer is working properly.

Adjust the Laminator Thermostat

Temperatures for laminating:

Wet ID pictures 260–275°F (127–135°C)

Dry ID pictures 245–255°F (118–124°C)

- 1 Insert a screwdriver into the temperature control as shown.

Important: The control should not be turned more than 1/8 turn.

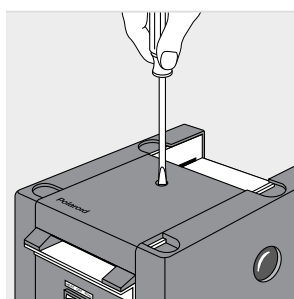

- 2 Turn the screwdriver toward:

the...	to...
+	increase the temperature
-	decrease the temperature

Storing the System

- 1 Turn the power off. Allow unit to cool completely before storing.
- 2 Disconnect the power cord from the electrical outlet and then from the socket on the camera base. When disconnecting the power cord, grasp the plug, not the cord, to prevent damage.
- 3 Store the power cord in the camera base.
- 4 Pull out the knob on the side of the camera, and tilt the camera down into its storage position.

Troubleshooting

No Leader Tab?

- 1 Open the film door without moving the film pack.
- 2 Push the leader tab out.
- 3 Close and latch the door.

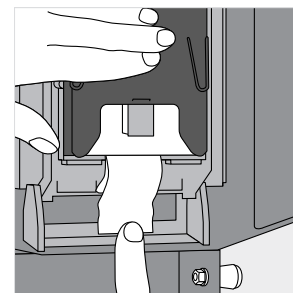

No Processing Tab?

Note: After pulling out a new processing tab, you will need to rephotograph the ID cards that were on that sheet of film.

- 1 Do not pull another leader tab.
- 2 Carefully open the holder far enough to get a finger on top of the film pack to hold it in position.

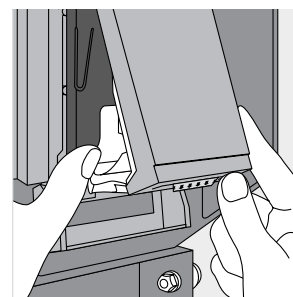

- 3 Grab the top processing tab and gently pull it all the way out and discard it.
- 4 Inspect the rollers and clean them if necessary. See the section *Clean the Developer Rollers*.
- 5 Close and latch the door, make sure the next leader tab is sticking out.

Problem/Solution Table

Problem	Solution
Repeated, evenly-spaced spots	Dirt on the steel developer rollers. See the section <i>Clean the Developer Rollers</i> .
Missing corners or orange-red marks along the edges	Processing tab was pulled out at an angle or dried developer on the rollers and film tab slot. See the section <i>Clean the Developer Rollers</i> .
Elongated picture	When the processing tab was pulled, the leader tab was pulled back into the holder.
Many small white specks	Processing tab was pulled out too fast. This also can cause pink lines, streaks or blotches on picture.
Muddy looking picture	The picture was not processed long enough.
Very light image, or none at all	The film was overexposed. Do not remove the black safety cover before inserting the film pack into the holder.
Nearly black or solid black picture	Insufficient or no exposure. Be sure you have pulled the black safety cover out of the film holder.
Broad streak or curtain-shaped mark	Processing tab was pulled out incorrectly, avoid hesitating or stopping.

Technical Assistance

Within the U.S.A. and Canada, call toll free 1-800-432-5355, Monday–Friday, 8:00 am – 8:00 pm (EST), fax 781-386-9688, or write to Polaroid Customer Care Center, 201 Burlington Road, Bedford, MA 01730. Outside the U.S.A., please contact the nearest Polaroid Office (see back cover for a list of addresses and phone numbers).

One Year Limited Warranty

Polaroid will, at our option repair or replace any camera found defective in manufacture within the warranty period. The warranty period is determined by the date of camera purchase. Keep the receipt as proof of purchase. Otherwise, the warranty period is determined by the date of manufacture. **This warranty does not apply to damage caused by accident, misuse or tampering, and excludes all consequential damages except in jurisdictions not allowing such exclusions or limitations.**

Radio and television interference

Warning: Changes or modifications to this unit not expressly approved by the party responsible for compliance could void the user's authority to operate the equipment.

FCC Notice (U.S.A.)

This equipment has been tested and found to comply with the limits for a Class B digital device, pursuant to Part 15 of the FCC rules. These limits are designed to provide reasonable protection against harmful interference in a residential installation. This equipment generates, uses and can radiate radio frequency energy and, if not installed and used in accordance with the instructions, may cause harmful interference to radio communications.

However, there is no guarantee that interference will not occur in a particular installation. If this equipment does cause harmful interference to radio or television reception, which can be determined by turning the equipment off and on, the user is encour-

aged to try to correct the interference by one or more of the following measures:

- Reorient or relocate the receiving antenna.
- Increase the separation between the equipment and receiver.
- Connect the equipment to an outlet on a circuit different from the one to which the receiver is connected.
- Consult the dealer or an experienced radio/television technician for help.

EMI Notice (Canada)

This digital apparatus does not exceed the Class B limits for radio noise emissions from digital apparatus set out in the Radio Interference Regulations of the Canadian Department of Communications.

LE PRESENT APPAREIL NUMERIQUE N'EMET PAS DE BRUITS RADIOELECTRIQUES DEPASSANT LES LIMITES APPLICABLES AUX APPAREILS NUMERIQUES DE CLASS B PRESCRITES DANS LE REGLEMENT SUR LE BROUILLAGE RADIOELECTRIQUE EDICTE PAR LE MINISTERE DES COMMUNICATIONS DU CANADA.

EMC Notice (Germany)

Polaroid garantiert, daß dieses Gerät die nachstehend aufgeführten Internationalen Standards erfüllt:

- die Vorschriften für RF-Störungen laut EN55022 Klasse B
- die Anforderungen für Funkenschutz laut EN50082-1, IEC 801-2, IEC 801-3, IEC 801-4.

Use only a harmonized detachable cordset that has conductors with a cross sectional area equal to or greater than 1.0mm. This cord shall be rated for 220-240VAC, 10 Amperes. It should be approved by a European agency such as VDE, SEMKO, ASTA or VTE.